

# Part IV

## Project Options Considered



## OPTIONS – DISTRICT-WIDE MASTER PLAN

### OPTION 20

BUILDING/SITE	NEW GRADE STRUCTURE	DISPOSITION	REVISED BUILDING CAPACITY
Neidig	K-5	Add & Renovate	600
Pfaff	K-5	Maintain	492
Quakertown	K-5	Maintain (for the moment)	259
Richland	K-5	Renovate (could add later)	384
Tohickon Valley	Close	Sell	0
Trumbauersville	K-5	Maintain	430
New Elementary	K-5	New	600
<b>TOTAL ELEMENTARY</b>			<b>2765</b>
Milford	6-8	Maintain (for the moment)	319
Strayer	6-8	Maintain	868
New Middle School	When needed	Construct when needed	(600 – later phase)
<b>TOTAL MIDDLE</b>			<b>1787 (with later phase)</b>
Freshman Center	9	Renovate	571
High School	10-12	Maintain	1455
<b>TOTAL HIGH</b>			<b>2026</b>
<b>TOTAL</b>			<b>6578</b>

QUAKERTOWN COMMUNITY SCHOOL DISTRICT



## OPTIONS – DISTRICT-WIDE MASTER PLAN

### COMMUNITY FACILITIES COMMITTEE RECOMMENDATION/SCHOOL BOARD ACTIONS

- Close Milford Middle School
  - Consolidate 7<sup>th</sup> and 8<sup>th</sup> graders at Strayer Middle School.
- Close Tohickon Valley Elementary School
- Convert 9<sup>th</sup> Grade Freshman Center to 6<sup>th</sup> Grade Center
  - Move Freshman to newly renovated and expanded High School: 9-12 High School grade structure.
- The above recommendations/actions have been executed.

### ELEMENTARY REASSIGNMENT COMMITTEE

- Renovations and additions to Neidig Elementary School to accommodate approximately 600 students.
- Redistrict elementary schools to Neidig, Quakertown, Pfaff and Trumbauersville Elementary Schools.

As proposed by the Elementary Reassignment Committee, the Board approved to renovate and add onto Neidig Elementary School, retaining the SCHRADERGROUP in November of 2017 to begin the design. Once completed, the District will implement the redistricting to realign attendance zones and building capacities.

# Part V

## Project Description



## PROJECT DESCRIPTION

- Educational Specification Overview
- Site Plan
- Floor Plans

Renovations	32,381 s.f.
Additions	50,992 s.f.
Total	83,373 s.f.
- Views
- PlanCon Room Schedules
- PlanCon Maximum Project Cost
- PlanCon Maximum Construction Cost (Act 34 Cost)
- PlanCon Aggregate Building Expenditure Standard

# **PROPOSED SITE PLAN**

Proposed Elementary School

SITE PLAN

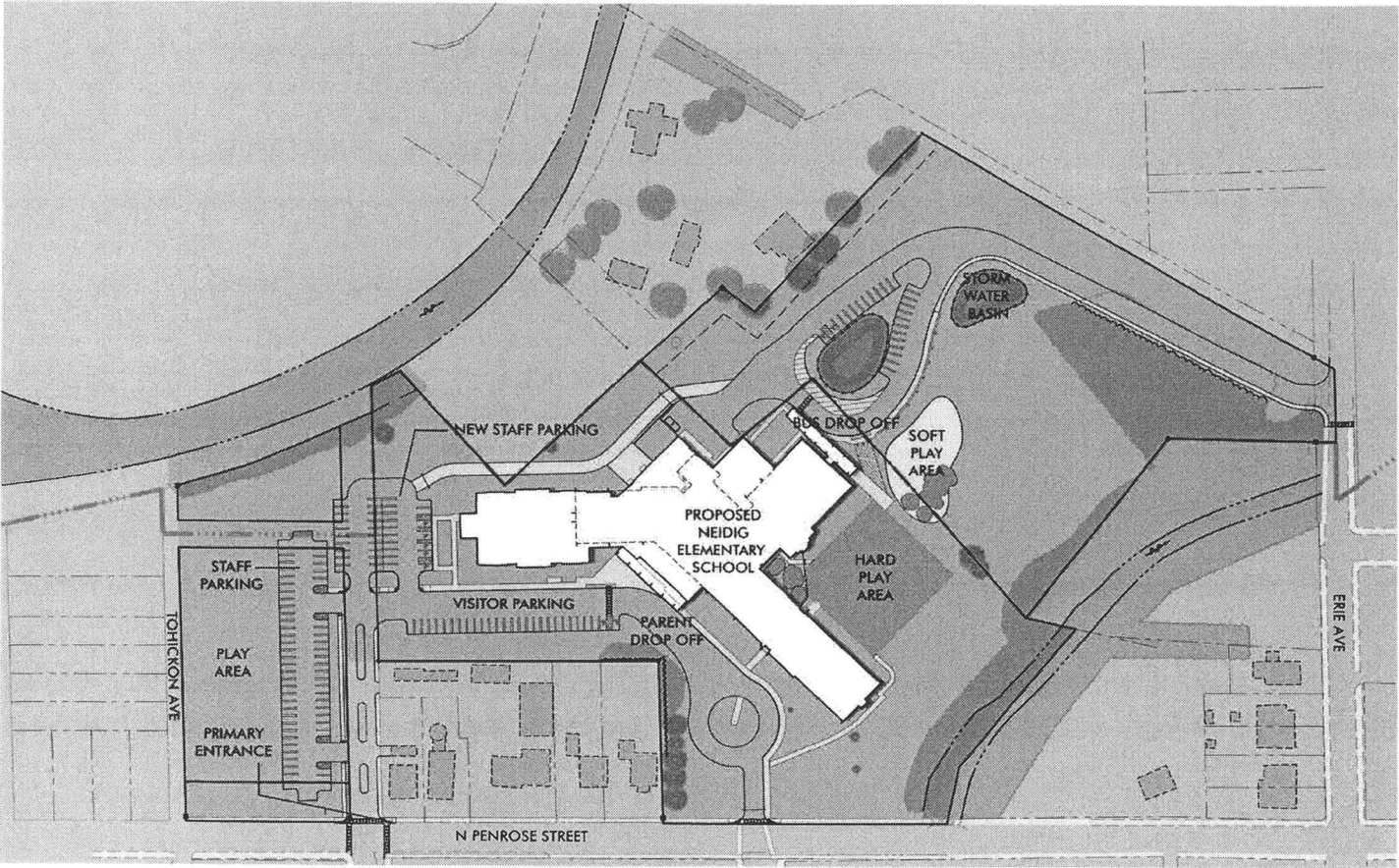

# **PROPOSED BUILDING PLANS**

## **Proposed Elementary School**



## FIRST FLOOR PLAN

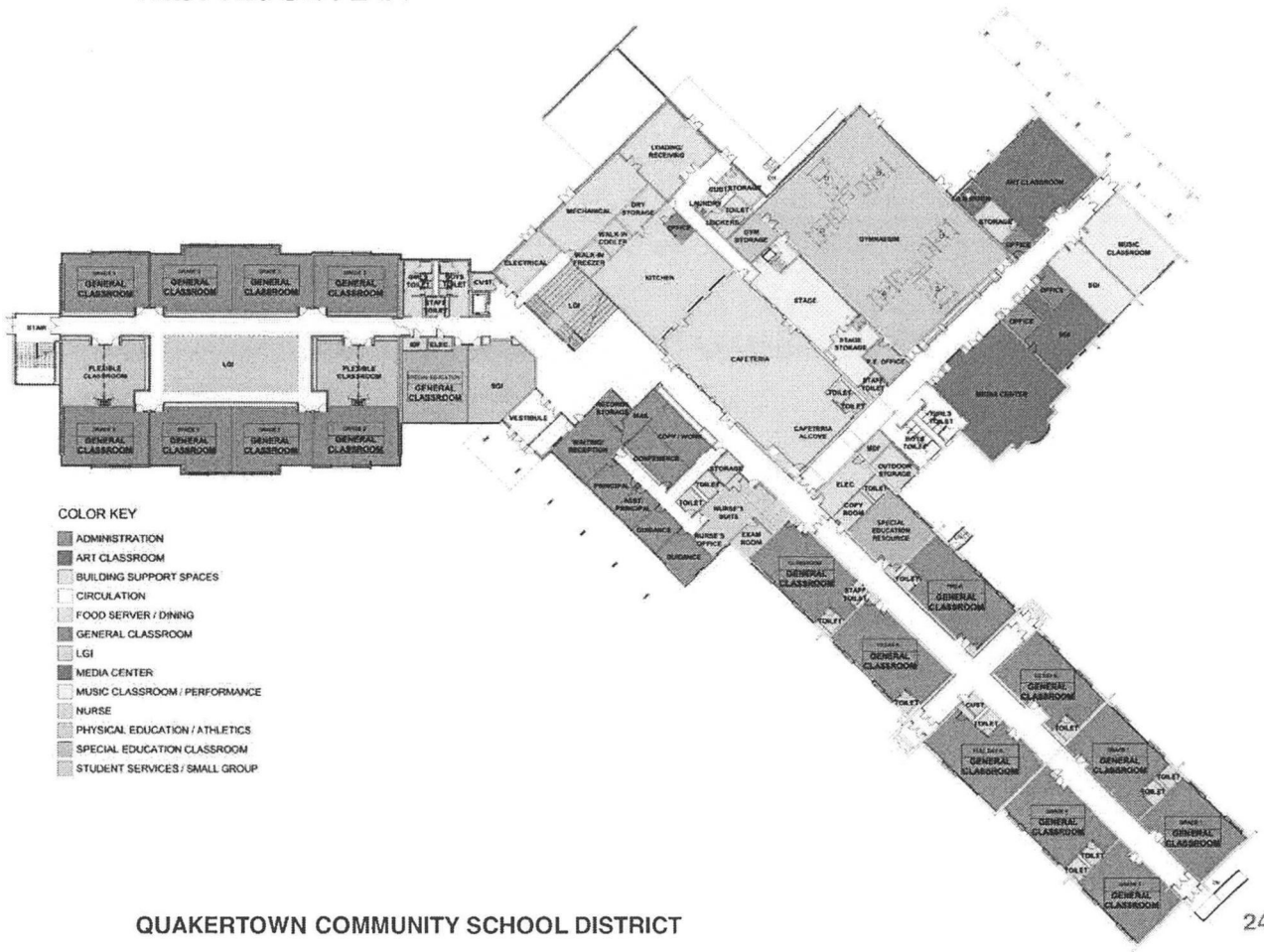

QUAKERTOWN COMMUNITY SCHOOL DISTRICT

## SECOND FLOOR PLAN

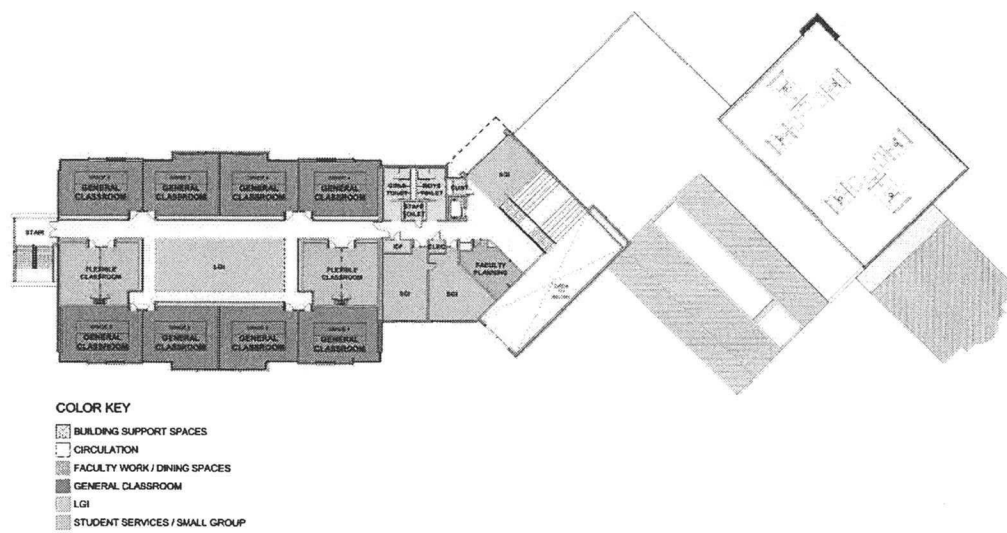

# **BUILDING RENDERINGS**

## **Proposed Elementary School**

**VIEW OF PROPOSED RENOVATIONS AND ADDITIONS FROM  
NORTH PENROSE STREET**

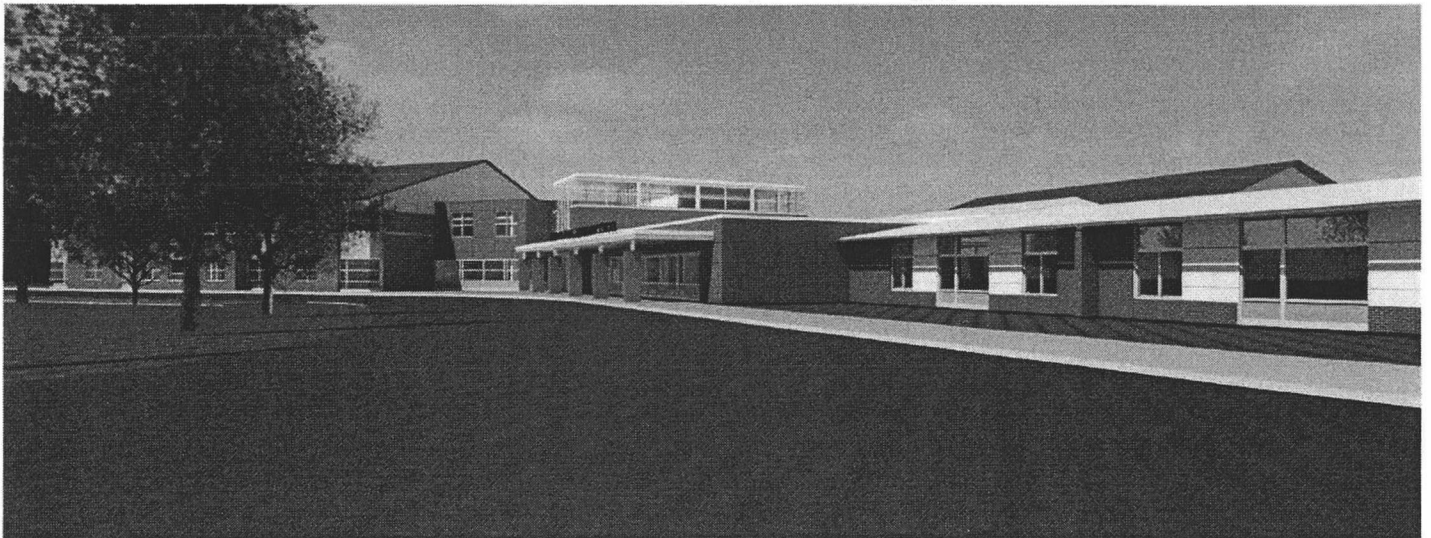

APPROACH TO NEW MAIN ENTRANCE

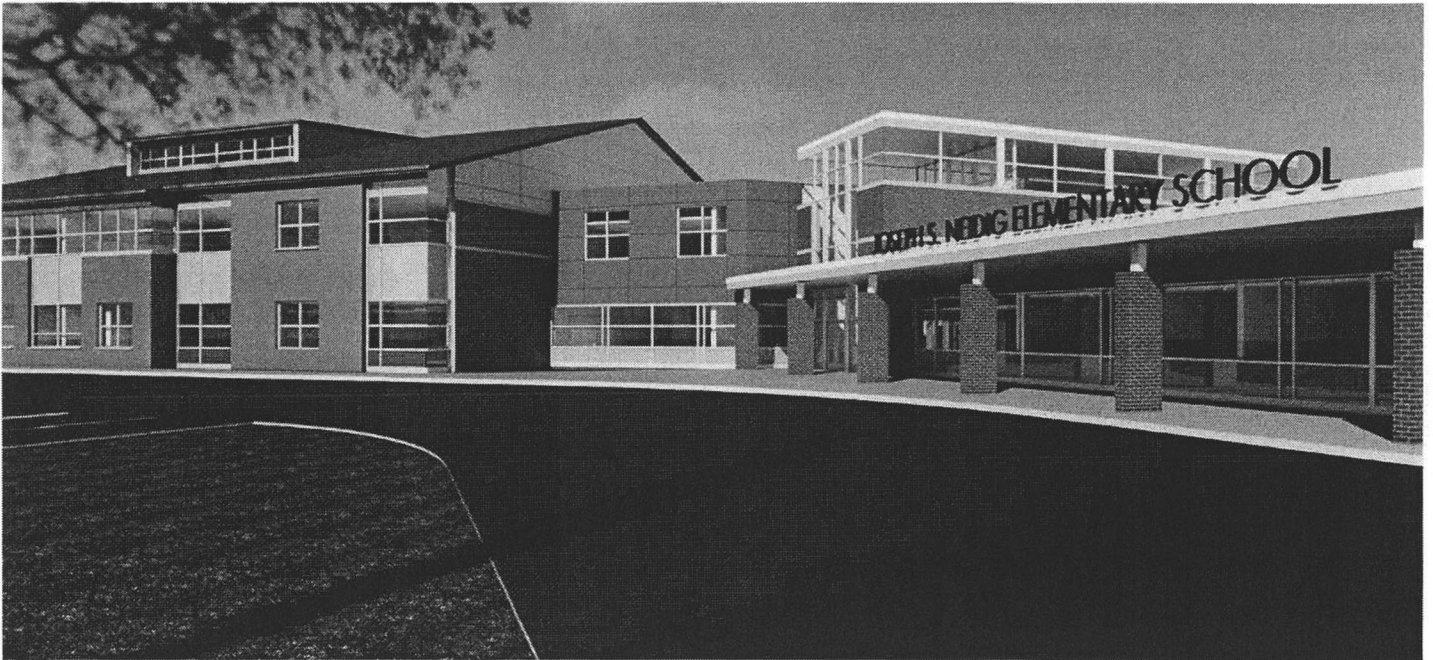

NEW FRONT ENTRANCE OF PROPOSED ELEMENTARY SCHOOL

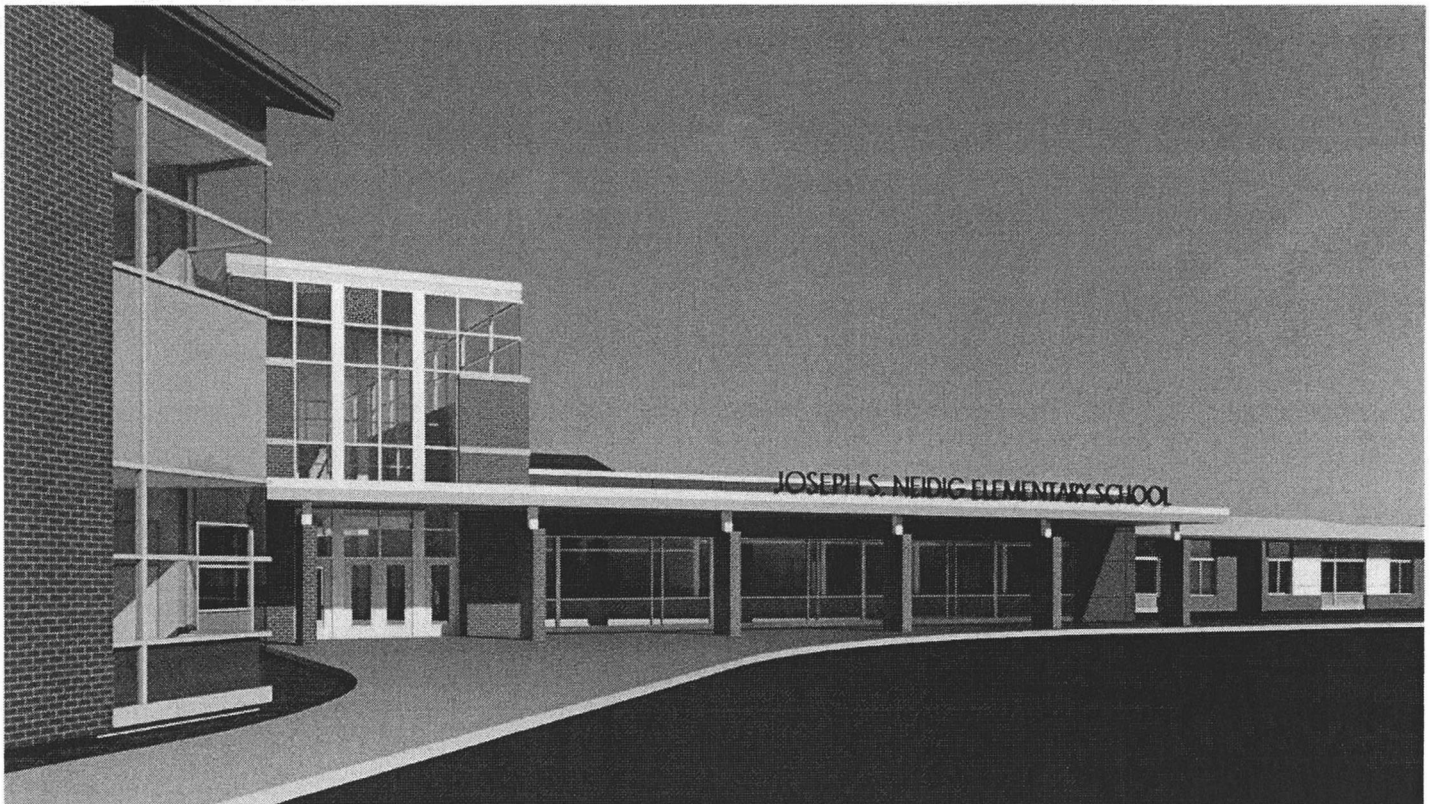

QUAKERTOWN COMMUNITY SCHOOL DISTRICT

REAR VIEW OF AT NEW BUS DROP-OFF/ENTRANCE

